

Volcano[®] HYBRID

QUICK START MANUAL

This QUICK START MANUAL will guide you through the main steps on how to use your new VOLCANO HYBRID with the Tube or the Valve Balloon. For detailed directions always refer to the included Instructions for Use or contact us at info@storz-bickel.com.

Please clean the Mouthpieces before use.

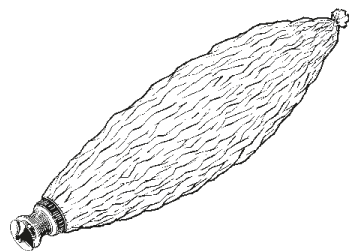

TUBE

Do not overfill!

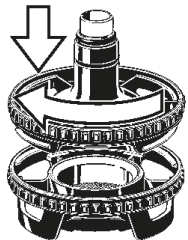

1. Fill Filling Chamber with ground substance and screw on Filling Chamber Cap.

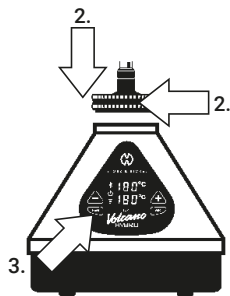

2. Screw on Filling Chamber.
3. Switch heat on.

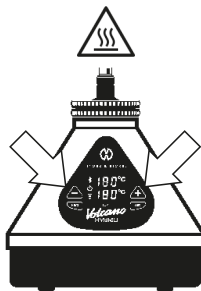

4. Choose temperature.
5. Wait until set value is equal to actual value (short acoustic signal of the air pump).

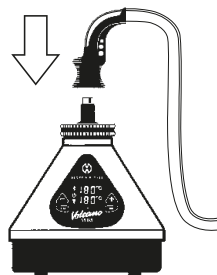

6. Put Tube on Filling Chamber.

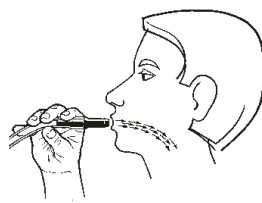

7. Inhale.

BALLOON

Do not overfill!

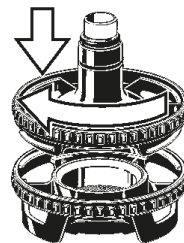

1. Fill Filling Chamber with ground substance and screw on Filling Chamber Cap.

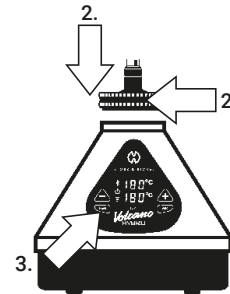

2. Screw on Filling Chamber.
3. Switch heat on.

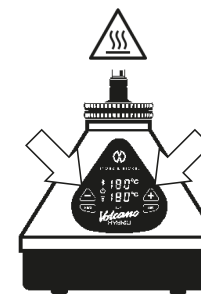

4. Choose temperature.
5. Wait until set value is equal to actual value (short acoustic signal of the air pump).

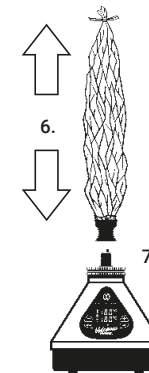

6. Pull Valve Balloon tight.
7. Put Valve Balloon on Filling Chamber.

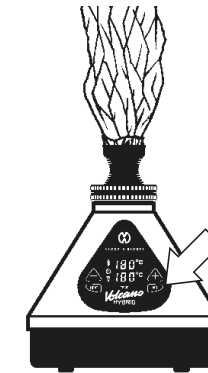

8. Switch Air Pump on.

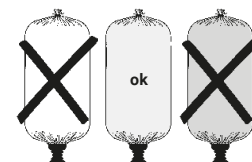

9. Observe vapor density.

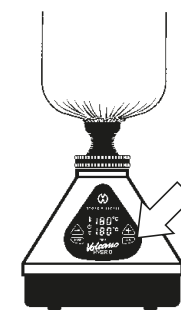

10. Turn off air pump.



11. Remove full Balloon Unit.

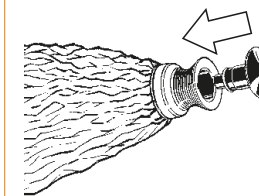

12. Attach Mouthpiece to Valve Balloon.

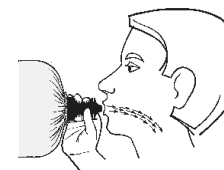

13. Inhale.

STORZ & BICKEL APP

Control your HYBRID via App

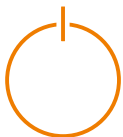

Get firmware updates



Save serial numbers



Adjust auto-shutoff



Personalize settings



Create workflows



Volcano[®]

HYBRID

QUICK START MANUAL

For more information visit www.storz-bickel.com

Compatible with Android 6.0 and above

